

Wave Cabinet Pull

Weight (lbs)
0.09–0.52

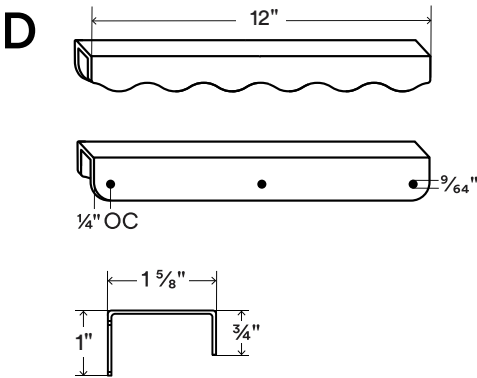
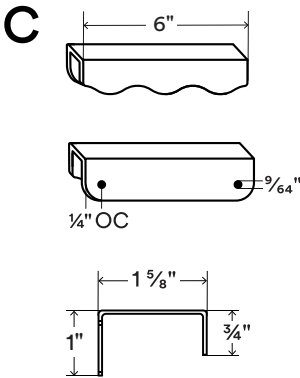
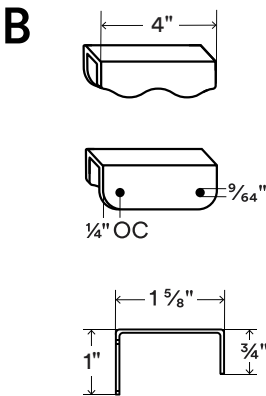
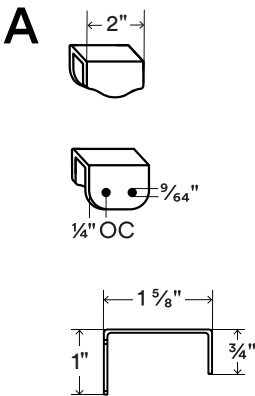

About Wave Cabinet Pull

Made from 18 gauge cold-rolled steel.

Fastener holes are set 1/4" OC from side edges of plate.

Fastener holes are 9/64" outside diameter (OD).

Manufactured from top-quality American steel made with 70% recycled content.

Designed & crafted by radically talented humans right here in the U.S. of Awesome.

Shelfology radically recycles all production metal, wood and cardboard waste.

* Drawings are representations only and not to scale.

© Shelfology 2025

Figure	Width	Height	Depth	Hook Material	Weight (lbs)
A	2"	3/4"	1 5/8"	Steel	0.09
B	4"	3/4"	1 5/8"	Steel	0.17
C	6"	3/4"	1 5/8"	Steel	0.26
D	12"	3/4"	1 5/8"	Steel	0.52

