

Shelfology
Certified Rad™

Designed & Crafted
By Radically Talented
Humans Right Here In
The U.S. Of Awesome_

→ Patent
Pending
Design.

⚡ Lightning
Fast Lead
Times.

Wallride Vertical Bike Hanger

Install Guide









Installation Difficulty Rating (1-10)

4

Table of Contents	Page
Installation Steps	004
Warnings	006
Rad Tips	007

Required Tools

Optional Tools

Drill 	Level 	Stud Finder 	1/4" Diameter Drill Bit 
Pencil 	T20 Torx Drill Bit 	Phillips Head Drill Bit 	

Crafted to elevate your bike from garage to gallery, Wallride Vertical Bike Hanger transforms any corner of your room into a showcase of style. Designed & Crafted By Radically Talented Humans Right Here In The U.S. Of Awesome.

What You'll Need



**LIGHTNING FAST
LEAD TIMES**



Installation Steps

001

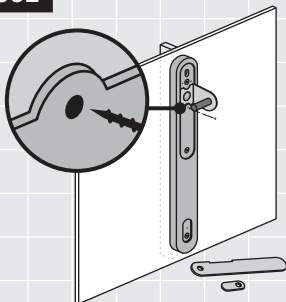

Yo, let's get started! Remove steel cover plates, and set aside. Your Wallride Vertical Bike Hanger features a bracket that can have the hook on either the right or left, so if you would like to switch the side that the hook is on, see **Rad Tip ①** on page 7.

Position your Wallride Vertical Bike Hanger on your wall in the desired location, ideally with center fastener holes aligned on studs or blocking. For more information on studs and blocking, see **Rad Tip ②** on page 7.

Use a drill to install one of the included truss head fasteners into the center

002

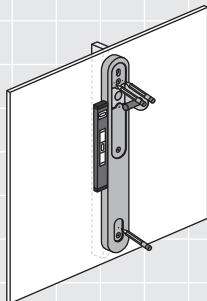

Use a level to vertically level your hanger. Mark remaining fastener hole locations with a pencil or fastener tip.

003

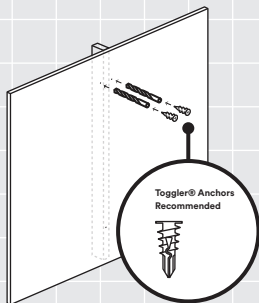

Remove your hanger from the wall. Using a 1/4" drill bit, predrill all fastener locations not on studs or blocking.

Install a wall anchor into all predrilled fastener locations. If you are using your own anchors, we recommend Toggler brand for best results.



004

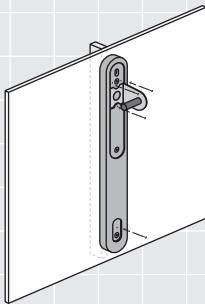

Replace your hanger and make final install of all matching truss head fasteners.

005

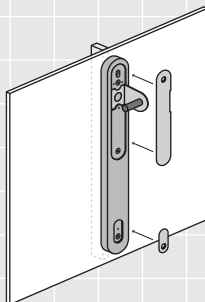

Replace steel cover plates.

006

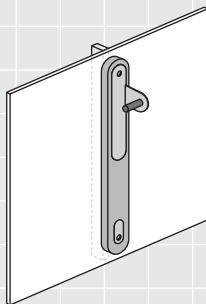

Stand back and relax, you did it! Give your cat a celebratory fist bump, if present. If you need more help, please reach out to a shelf geek today.

hello@shelfology.com
949.244.1083





Whoa, you made it! We are vicariously stoking for you right now. Post your sweet shelfie on Instagram now!



@shelfology
#radshelfie

Need a hand? Speak with a Shelf Geek at 949.244.1083 or hello@shelfology.com today.

How did we do? You'll get an email soon asking for a product review, and we'd be stoked if you oblige. You rock in advance!

Warnings



① **Correct Install Required For Safe Use**

1.1 Hangers must be correctly installed into studs or wall blocking. Failure to do so may result in sagging hangers, falling objects, or serious injury.

② **Adhere To The Capacity Rating Of Your Specific Hanger**

2.1 Every Shelfology product has been engineered for use with specific capacities. Failure to follow our specified capacity ratings may result in sagging hangers, falling objects, or serious injury. Please reference the Wallride Spec Sheet for more information.

③ **California Proposition 65 Warning**

3.1 This product contains chemicals known to the State of California to cause cancer and birth defects or other reproductive harm. Don't eat this hanger. If you live outside of California, do whatever you want. For more boring information, visit www.p65warnings.ca.gov.

④ **Not For Use In Wet Environments**

4.1 Powder coated carbon steel does not equal waterproof. If water has direct and constant contact with the hanger, like in a shower or outdoors, it will rust. Hangers installed in these conditions are not covered by our warranty.

① Bracket Orientation

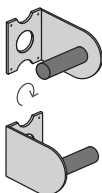

1.1 The orientation of your bracket is entirely up to you and the feng shui of your space.

To change the side the hook is on, simply use a Phillips drill bit to uninstall fasteners, rotate the bracket 180°, then reinstall fasteners to secure bracket into place.

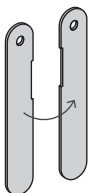

1.2 The cover plate is also reversible—don't forget to flip it so the notch in the side aligns with the bracket.

② Fasten Into All Studs & Blocking The Hanger Crosses

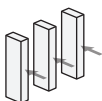

2.1 Studs are the vertical 2x4 boards that make up the bones of your walls. They provide solid structure for your hanger to attach to.

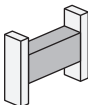

2.2 Blocking is typically added later between studs in the wall for additional support to mount your hanger to, and is usually made from 2x4 or 2x6 lumber.

Need a hand? Speak with a Shelf Geek at 949.244.1083 or hello@shelfology.com today.

How did we do? You'll get an email soon asking for a product review, and we'd be stoked if you oblige. You rock in advance!

Call	949.244.1083
Email	hello@shelfology.com
Shop	www.shelfology.com
Visit	156 N 2nd E Rexburg, ID 83440
Social	@shelfology

