

# Russel Wall Ladder

Load Capacity (lbs per bar)  
**150\***

Monkey Bar Weight (lbs)  
**1.35**

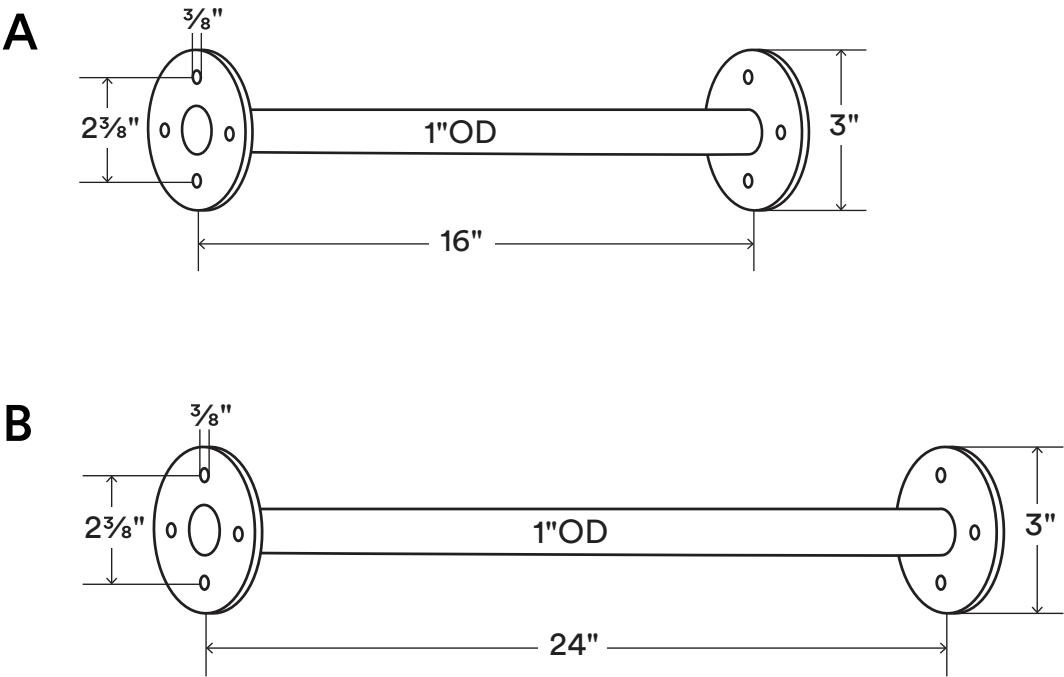

About Russel Wall Ladder

Made from 1"x 0.65" wall hollow plain carbon steel tubing, with 1/4" thick plain carbon steel mounting plates.

\*Supports 150 lbs. per handle when properly attached to adequate backing.

Fastener holes are 3/8" outside diameter (OD).

Designed, engineered & hand-finished in the U.S. of Awesome.

\*\*  
WARNING: All monkey bars must be installed into studs, joists, or blocking. Failure to do so may result in saggy product, falling objects, or even injury.

\*\*\*  
Drawings are representations only and not to scale.

Made In Vietnam.

© Shelfology 2026

Figure	Height	Width	Weight (lbs)	Load
A	3"	16"	1.35	150lbs
B	3"	25"	1.35	150lbs

➡ Patent Pending Design.

⚡ Lightning Fast Lead Times.