

Randle Basic Monkey Bar

Load Capacity (lbs per bar)
200*

Monkey Bar Weight (lbs)
1.35

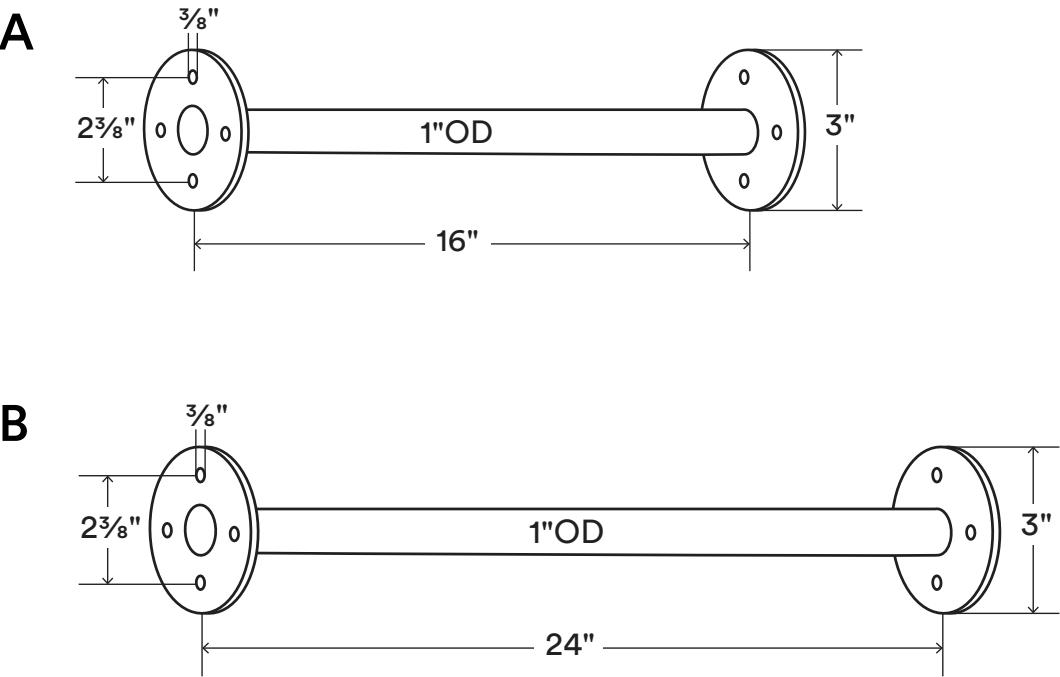

About Randle Basic Monkey Bar + Wall Ladder

Made from 1"x 0.65" wall hollow plain carbon steel tubing, with 1/4" thick plain carbon steel mounting plates.

*Supports 200 lbs. per handle when properly attached to adequate backing.

Fastener holes are 3/8" outside diameter (OD).

Designed, engineered & hand-finished in the U.S. of Awesome.

**
WARNING: All monkey bars must be installed into studs, joists, or blocking. Failure to do so may result in saggy product, falling objects, or even injury.

Drawings are representations only and not to scale.

Made In Vietnam.

© Shelfology 2025

Figure	Height	Width	Weight (lbs)	Load
A	3"	16"	1.35	200lbs
B	3"	25"	1.35	200lbs

Patent Pending Design.

Lightning Fast Lead Times.