

Shelfology
Certified Rad™

Designed & Crafted
By Radically Talented
Humans Right Here In
The U.S. Of Awesome_

→ Patent
Pending
Design.

⚡ Lightning
Fast Lead
Times.

Magnetic Print Hanging System

Install Guide





Installation
Difficulty
Rating (1-10)

3

Table of Contents	Page
Installation Steps	004
Warnings	006
Rad Tips	007

Required
Tools



Drill

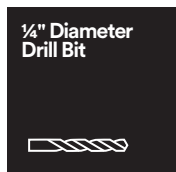

1/4" Diameter
Drill Bit

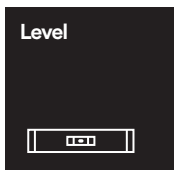

Level

Optional
Tools



Stud Finder

Unleash your walls
with the Magnetic
Print Hanging System,
crafted in sleek,
powder-coated
metal bursting with
all our vibrant colors.
Designed & Crafted
By Radically Talented
Humans Right Here In
The U.S. Of Awesome.

What You'll Need



1x



2x



1x



1x



LEAD TIMES -



Installation Steps

001

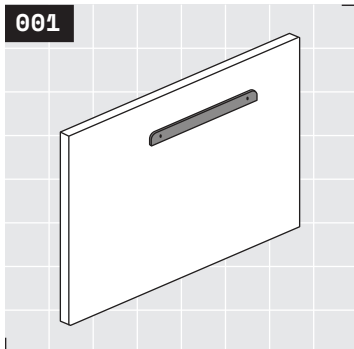

Yo! Here we go! Position top back plate on the wall in desired location.

002

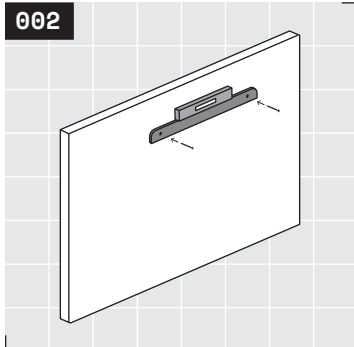

Level the plate, then install fasteners into both fastener holes.

003

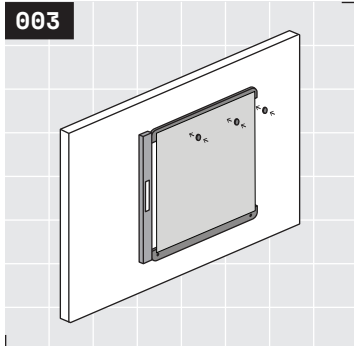

Evenly fasten art to the plate with provided magnets. Use the bottom edge of your artwork to position the bottom back plate. If needed, use your level to align the top and bottom plate. Repeat step ② for bottom plate. Take a swig of your favorite non-alcoholic brew.



004

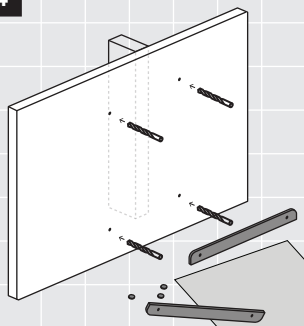

Remove all plates from wall. For any holes not crossing a stud or blocking, use your 1/4" drill bit to predrill for wall anchors. If you don't know what a stud or blocking is, refer to Rad Tip ①.

005

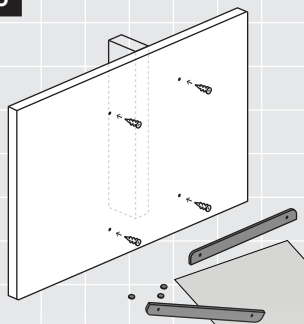

Install wall anchors into predrilled holes. Take another swig of your brew.

006

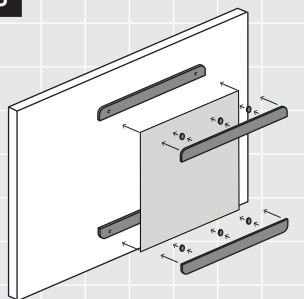

Reattach the backplates and your artwork with the magnets, and then put on your cover plates.

That's it! Sit back and admire. Finish off your soda, it's time to celebrate your innate awesomeness! If you need more help, please reach out to a shelf geek today.

hello@shelfology.com
949.244.1083

Whoa, you made it! We are vicariously stoking for you right now. Post your sweet shelfie on Instagram now!



@shelfology
#radshelfie

Need a hand? Speak with a Shelf Geek at 949.244.1083 or hello@shelfology.com today.

How did we do? You'll get an email soon asking for a product review, and we'd be stoked if you oblige. You rock in advance!

Warnings



① Correct Install Required For Safe Use

1.1 Print hangers must be correctly installed into studs, blocking, or the appropriate wall anchors. Failure to do so may result in sagging print hangers, falling objects, or serious injury.

② Adhere To The Capacity Rating Of Your Specific Brackets

2.1 Every Shelfology bracket weight class and length has been engineered for use with specific shelf capacities/dimensions. Failure to follow our specified capacity ratings and correct shelf dimensions may result in sagging shelves, falling objects, or serious injury. For more information, reference the Magnetic Print Hanging System Specification Sheet.

③ California Proposition 65 Warning

3.1 This product contains chemicals known to the State of California to cause cancer and birth defects or other reproductive harm. Don't eat this product. If you live outside of California, do whatever you want. For more boring information, visit www.p65warnings.ca.gov.

④ This Product May Make Others Incredibly Jealous

4.1 Any Shelfology Certified Rad™ product should be flaunted with caution around friends, loved ones, and even complete strangers, as minimal or extreme jealousy may occur. Shelf responsibly.



① Studs & Blocking

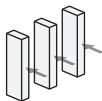

1.1 Studs are the vertical 2x4 boards that make up the bones of your walls. They provide solid structure for your print hangers to attach to.

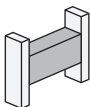

1.2 Blocking is typically added later between studs in the wall for additional support to mount print hangers to, and is usually made from 2x4 or 2x6 lumber.

DESIGNED & CRAFTED BY RADICALLY TALENTED
HUMAN'S RIGHT HERE IN THE U.S. OF AWESOME.

LIGHTNING FAST
LEAD TIMES.

Need a hand? Speak with a Shelf Geek at 949.244.1083 or hello@shelfology.com today.

How did we do? You'll get an email soon asking for a product review, and we'd be stoked if you oblige. You rock in advance!

Call	949.244.1083
Email	hello@shelfology.com
Shop	www.shelfology.com
Visit	156 N 2nd E Rexburg, ID 83440
Social	@shelfology

