

Shelfology
Certified Rad™

Designed &
Engineered In The
U.S. Of Awesome_

→ Patent
Pending
Design.

⚡ Lightning
Fast Lead
Times.

Yuri XD Bracket

Install Guide





START ↓↓

Unleash the potential of your floating desk dreams with Yuri XD. Experience insane strength worthy of Clark Kent himself. Designed & Engineered In The U.S. Of Awesome. Rad!

What's In The Box

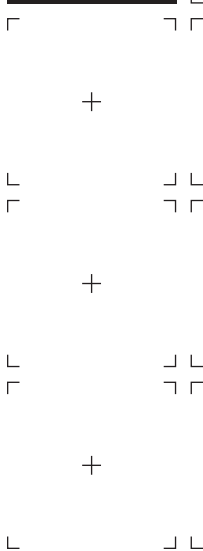

What You'll Need

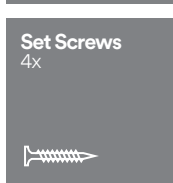

DESIGNED & ENGINEERED IN THE U.S. OF AWESOME.

LIGHTNING FAST LEAD TIMES.



Construction Method

① Pick Your Depth

② Use Any Desk Style

③ Hold Massive Weight

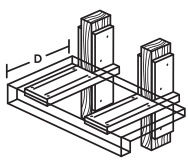

Bracket Rod Length	Desk Depth (D)
12" (XD)	12"-18"
18" (XD)	18"-24"
24" (XD)	24"-30"

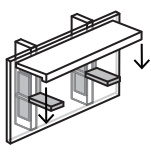

Weight capacity varies by desk depth, mounting surface and the number of fasteners secured through the bracket. Brackets must be installed correctly into studs and blocking. See Figure 1 below.

Nearly any desk slab size, shape, or design will work with the Yuri Bracket as support. We recommend spacing brackets every 32" or less.

Figure 1: Yuri Bracket Weight Capacities

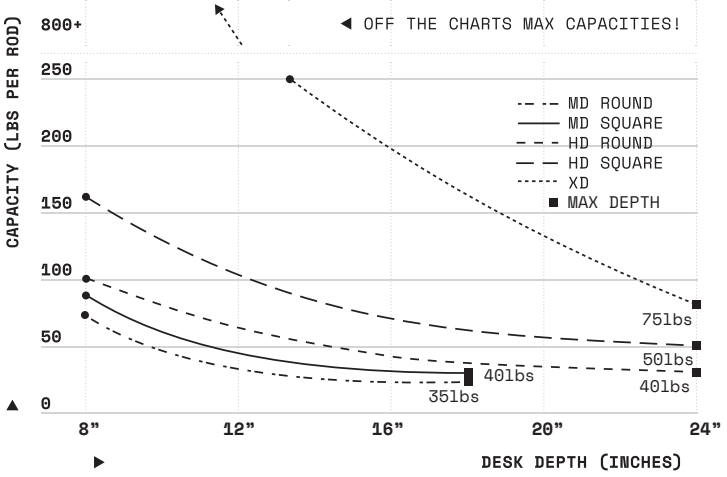



Installation Steps

001

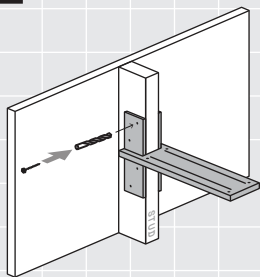

Yo, here we go! Position your first bracket on a stud or post in the desired location. See **Rad Tip** ① on page 8. Predrill lagscrew location using a $\frac{1}{8}$ " drill bit. Install a $\frac{1}{4}$ " lagscrew into an upper fastener hole.

002

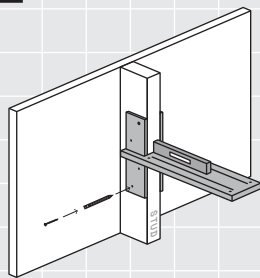

Straighten the bracket using a level. Mark a lower fastener hole location with a fastener tip or a pencil. Predrill location with $\frac{1}{8}$ " drill bit.

003

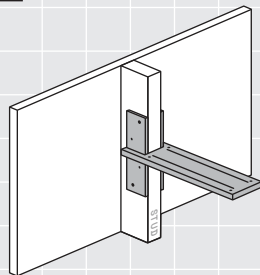

Install a second lagscrew into second location. Recheck for level. Predrill and install lagscrews into remaining holes.



004

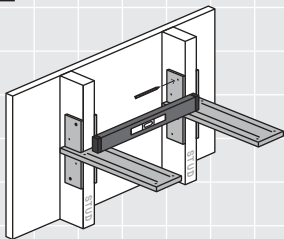

After installing your first bracket, hold the second bracket in position. We recommend spacing brackets 2" or less apart. Use a level to align both brackets horizontally. Mark an upper fastener hole location for the second bracket. See **Rad Tip** © on page 8.

005

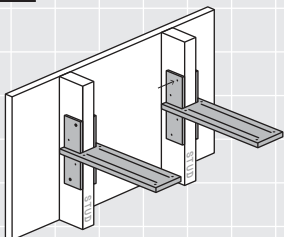

Install upper lag screw in marked location. Repeat steps 2 and 3. Once you have installed all brackets, you are ready for drywall.

006

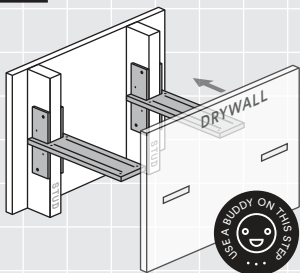

To finish your installation, measure and cut holes in your drywall or wall sheeting large enough to accept the bracket supports. Move wall sheeting into place around brackets and secure it to the wall.

007

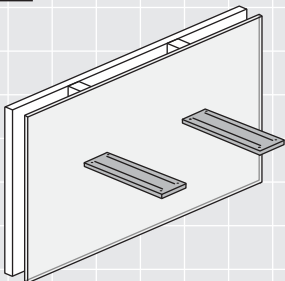

If needed, seal gaps around bracket supports with drywall joint compound. See **Rad Tip** © on page 8. Texturing and painting the wall surface behind the desk slab is recommended before desk installation.



008

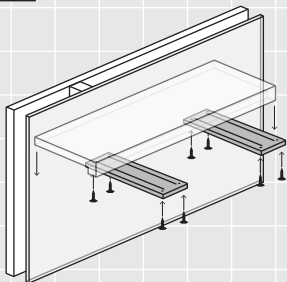

Position desk slab. If you ordered pre-drilled rods, install set screws into desk through rod holes to secure it in place. If not, see **Rad Tip** © below for more information and for slab recommendations.

009

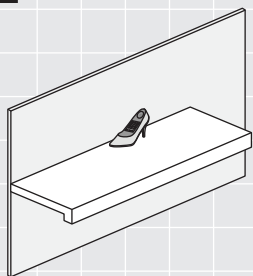

You are done! give your cat a celebratory fist bump if present. Gently place your authentic 1980's high-heel shoe phone on desk and admire.

Whoa, you made it! We are vicariously stoking for you right now. Post your sweet shelfie on Instagram now!

@shelfology
#radshelfie

Need a hand? Speak with a Shelf Geek at 949.244.1083 or hello@shelfology.com today.

How did we do? You'll get an email soon asking for a product review, and we'd be stoked if you oblige. You rock in advance!



DESIGNED & ENGINEERED IN
THE U.S. OF AWESOME.

LIGHTNING FAST
LEAD TIMES.



Rad Tips



① Fasten into Studs

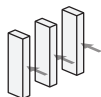

1.1 The Yuri bracket is designed to be mounted on a fixed stud, post, or other structural surface. Drywall is not structural, and will not support this bracket.

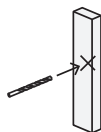

1.2 Predrilling a $\frac{1}{8}$ " pilot hole in the desired lagscrew location will ensure accurate fastener placement, and prevent splitting of the stud or post.

② How to Make a Longer Level



2.1 You can turn a short level into a long one by laying it on a straight object like a yard stick. Just hold it in place with your bullet level on top and measure!

③ Protecting the Finish

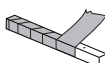

3.1 Covering the bracket support rod with low-tack removable tape will protect the finish during drywall installation, sanding, and painting. Remove tape before installing desk.

3.2 If you did not order set screw holes with your bracket, this is a perfect time to use a $\frac{1}{8}$ " drill bit and drill out two lovely set screw locations for a solid slab install.

④ Securing the Right Slab



4.1 At least $\frac{3}{4}$ " thick solid hardwood, or manufactured desk slab is recommended to avoid sag. See shelfology.com, or call 949-244-1083 to order slabs made to measure.

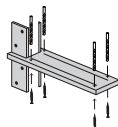

4.2 To secure your slab to the brackets, we recommend drilling at least two vertical holes in each support rod with a $\frac{3}{16}$ " drill. Install set screws through these locations.



Notes

DESIGNED & ENGINEERED IN
THE U.S. OF AMERICA.

LIGHTNING FAST
LEAD TIMES.

Warnings



① Correct Install Required For Safe Use

1.1 Desk brackets must be correctly installed into studs or wall blocking. Failure to do so may result in sagging desks, falling objects, or serious injury.

② Adhere To The Capacity Rating Of Your Specific Bracket

2.1 Every Shelfology bracket weight class and length has been engineered for use with specific capacities/dimensions. Failure to follow our specified capacity ratings and correct desk dimensions may result in sagging desks, falling objects, or serious injury. For more information, refer to the Yuri XD specification sheet.

③ California Proposition 65 Warning

3.1 This product contains chemicals known to the State of California to cause cancer and birth defects or other reproductive harm. Don't eat this bracket. If you live outside of California, do whatever you want. For more boring information, visit www.p65warnings.ca.gov.

④ This Product May Make Others Incredibly Jealous

4.1 Any Shelfology Certified Rad™ product should be flaunted with caution around friends, loved ones, and even complete strangers, as minimal or extreme jealousy may occur. Shelf responsibly.

DESIGNED & ENGINEERED IN
THE U.S. OF AMESOME.

LIGHTNING FAST
LEAD TIMES.

Need a hand? Speak with a Shelf Geek at 949.244.1083 or hello@shelfology.com today.

How did we do? You'll get an email soon asking for a product review, and we'd be stoked if you oblige. You rock in advance!

Call 949.244.1083
Email hello@shelfology.com
Shop www.shelfology.com
Visit 156 N 2nd E Rexburg, ID 83440
Social @shelfology

